

**IF YOU HAVE ANY QUESTIONS, COMMENTS, OR FEEDBACK
PLEASE CONTACT CUSTOMER SERVICE**

1-866-456-8852

jlacs@jlahome.com

TABLE OF CONTENTS

QUICK SETUP PROCEDURES 1
CONTROLLER SETTINGS/TROUBLESHOOTING 2
SAFETY ESSENTIALS 3
CARE INSTRUCTIONS/WARRANTY 4

SET UP PROCEDURES

DO NOT PLUG INTO WALL OUTLET UNTIL YOU CONNECT THE CONTROLLER CORD TO THE CONNECTOR

1. Locate Connector on the product near the care instruction label.
2. To plug onctroller cord into the connector, match the arrow on the power cord to the arrow on the connector, push together until they lock.
3. Plug cord into a 120 Volt AC wall outlet.

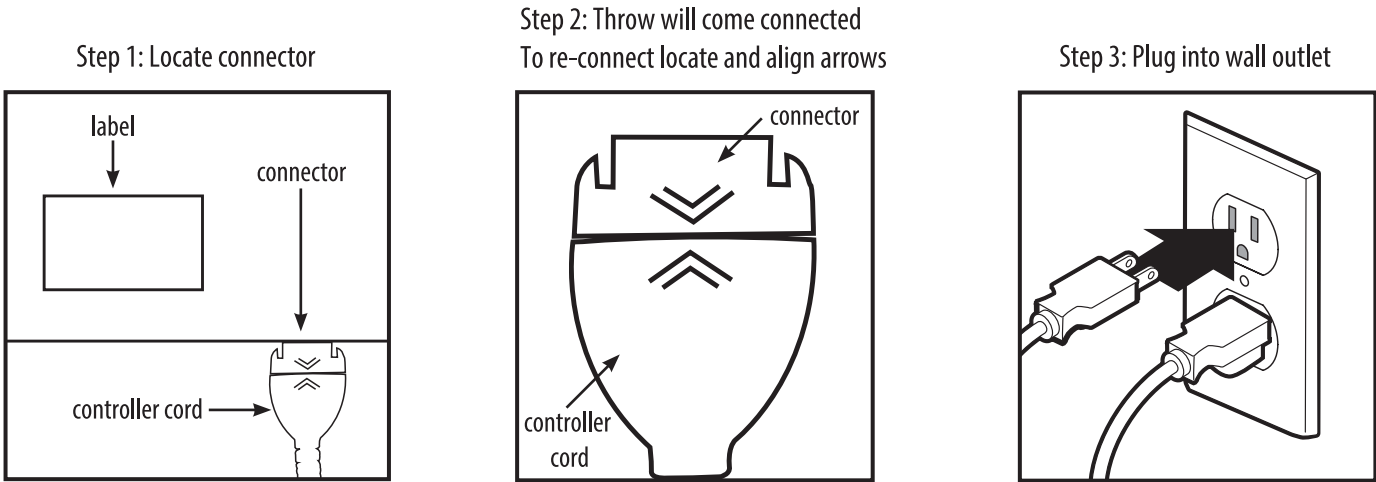

Other tips and things to know:

1. All cords must be tangle free and not trapped or pinched in any way. Ensure no trapping or pinching between mattress and box spring, sofa cushions, against wall or furniture.
2. Do not wrap the controller in the product when in use.
3. To disconnect the controller, first unplug the power cord from the wall outlet, then pinch the sides of the controller chord and pull apart.

CONTROLLER SETTINGS

1. Push the power button to turn on (Fig.1)
2. The controller will default to the lowest setting. Continue to press the power button to adjust the temperature. The light will illuminate the selected heat setting.
3. To turn the controller off, press the power button until no lights is seen on the control pad (Fig.1)
4. Caution: If the throw has not been properly connected, the ligh will be blinking
5. **AUTO SHUTOFF FEATURE** Each controller automatically shuts off after 4 hours. This is designed to provide added safety and conserve energy. To reactivate the heating feature simply press the power button. To restart after a power outage simply press the power button.

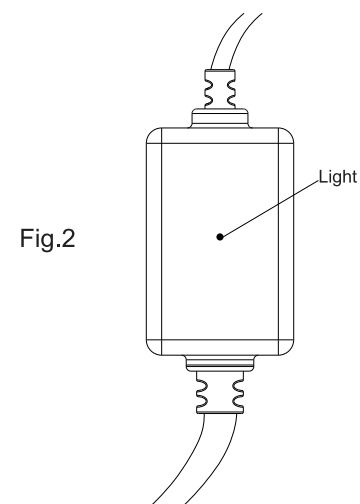
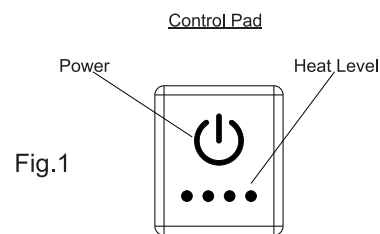

TROUBLE SHOOTING

Q: The indicator light on my controller is flashing.

A: Turn the controller. Unplug the controller from the wall outlet. Unplug the controller cord from the throw connector. Wait 30 seconds and reconnect to the throw making sure the arrows are properly aligned. Now plu ginto the 120 volt wall outlet.

Q: The controller is lit but the product does not heat up.

A: Test the product by folding the textile over itself and turning the setting to high. Ensure the light is on. After approximately five minutes, carefully feel between the layers.

Caution: Never leave the product turned on and folded up for more than minutes.

Q: The product warms but does not get hot

A: This product is not like a heating pad. In normal operation it does not feel hot to the touch, however the warmth is evident when in use.

Q: Why is my controller warm?

A: A small ount of heat is produced when transferring power from the wall to the product. The warmth is completely normal.

Q: The blanket is too warm.

A: Please ensure no other bedding like quilts, blankets, comforters are on top of the heated blanket. The air gets trapped between the layers.

For additional product information,
Visit our website <https://peacefulnights.info>,
or scan this code.



IMPORTANT INSTRUCTIONS KEEP FOR FUTURE REFERENCE

To operate your product properly and safely, take the following safety precautions you need to follow. As with all electrical appliances, there is an inherent danger of overheating, fire or personal injury if the product is not used correctly.

Please carefully read all instructions before using the warming product.

SAFETY ESSENTIALS

Maintenance & SAFETY: Read all instructions:

Manufacturer is not responsible for personal injury, animal injury, damage to product, or damage to property if product is used improperly.

- This product should never be balled up or bunched in any way when in use. This may result in over heating.
- Do not use this product with an air mattress.
- Do not use this product with infants.
- Do not use with generator power.
- Do not use this product on any individual who is insensitive to heat or has poor blood circulation.
- Do not use if Diabetic
- If improper operation of this product is observed, discontinue its use immediately.
- Do not use with an extension cord.
- Do not put other bedding like quilts, blankets, comforters on top of heated blanket. The hot air gets trapped between layers.
- Do not use with pets or animals
- Do not use if wet. If spills occur, turn product off, unplug and dry before re-using
- Turn off heated prouduct when not in use.
- Do not sleep while using this product.

FCC:

Note: This equipment has been tested and found to comply with the limits for a Class B digital device, pursuant to part 15 of the FCC Rules. These limits are designed to provide reasonable protection against harmful interference in a residential installation. This equipment generates, uses and can radiate radio frequency energy and, if not installed and used in accordance with the instructions, may cause harmful interference to radio communications. However, there is no guarantee that interference will not occur in a particular installation. If this equipment does cause harmful interference to radio or television reception, which can be determined by turning the equipment off and on, the user is encouraged to try to correct the interference by one or more of the following measures:

- Reorient or relocate the receiving antenna.
- Increase the separation between the equipment and receiver.
- Connect the equipment into an outlet on a circuit different from that to which the receiver is connected.
- Consult the dealer or an experienced radio/TV technician for help.

Changes or modifications not approved by E&E Co. Ltd. could void the users authority to operate this equipment

CARE INSTRUCTIONS

IMPORTANT: NEVER PLUG IN THIS PRODUCT WHILE DAMP

CARE INSTRUCTIONS

- Disconnect the cord from this product.
- Do not submerge cord.
- Built-in power button is safe to wash.
- Machine wash gentle cycle and in cold water.
- Do not dry clean this product.
- Do not bleach.
- Cleaning solvents may have a deteriorating effect on the insulation of the heating element.

DRYING INSTRUCTIONS

- Tumble dry on low heat.
- Built-in power button is safe to dry.
- Ensure this product has enough room to tumble freely
- Do not iron this product
- Do not use dryers at your local laundromat as they tend to get too hot and damage the wires of your heated product.

WARRANTY

No warranty will be granted without the original receipt, gift receipt or copy thereof.

E&E CO. Ltd. MAKES NO OTHER WARRANTIES, EXPRESS OR IMPLIED, NOT OTHERWISE SPECIFIED HERE IN:

To Obtain Warranty Service

For any questions you may have about your warming product, please contact E&E CO. Ltd. customer service at 1-866-456-8852. If you have recently purchased this item, within the last 30 days, please return the item to the original place of purchase for a full refund or exchange.

If instructed to return your product for repair or replacement by our customer service department, attach a tag to the product (do not use pins) that includes your name, address and daytime telephone number. Please include a copy of the original sales receipt. Carefully package (clean and pet-hair free) the product. Use UPS or parcel post, with shipping and insurance prepaid. Ship the product only to the address provided by Customer Service, NOT the address listed above.

E&E Co. Ltd.
45875 Northport Loop East
Fremont, CA 94538

E&E CO. Ltd. warrants that for a period stated below from the date of purchase, this product will be free from defects in material and workmanship. This warming product manufactured by E&E CO. Ltd. will carry a THREE year limited warranty. E&E CO. Ltd., at its option, will repair this product or any component of the product found to be defective during the warranty period. Replacement will be made with a new or remanufactured product or component. If the product is no longer available, replacement may be made with a similar product of equal or greater value. This is your exclusive warranty. This warranty is valid for the original retail purchaser from the date of initial retail purchase and is not transferable. Keep the original sales receipt. Proof of purchase is required to obtain warranty performance. E&E CO. Ltd., or any retail stores selling the E&E CO. Ltd. products do not have the right to alter, modify, or any way change the terms and conditions of this warranty.

This warranty does not cover normal wear of parts or damage resulting from any of the following negligent use or misuse of the product: use on improper voltage; or current, or use contrary to the operating instructions, disassembly, repair or alteration by anyone other than E&E CO. Ltd. Further, the warranty does not cover Acts of God, or Nature, such as fire, flood, hurricanes and tornadoes. E&E CO. Ltd. shall not be liable for any incidental or consequential damages caused by the breach of any express or implied warranty. Except to the extent prohibited by applicable law, any implied warranty of merchantability or fitness for a particular purpose is limited in duration to the duration of the above warranty. Some states, provinces or jurisdictions do not allow the exclusion or limitation of incidental or consequential damages or limitations on how long an implied warranty lasts, so the above limitations or exclusion may not apply to you. This warranty gives you specific legal rights, and you may also have other rights that vary from state to state or province to province.